

Rotary Airlock Application Form

schenckprocess



Name		Job Title	Company Name	
First Name	Last Name			
Address				
Street Address Line		City	State	Zip Code
Country				
Phone Number		Email		
Area Code	Phone Number			

Is it a Replacement or New Application?

Replacement

New Application

Manufacturer	Model Number	Serial Number
--------------	--------------	---------------

Location

Indoors

Outdoors

Hazardous Area Certification

Equipment Above Rotary Valve

Chute

Shredder

Screw

Vac. Line

Cyclone

Belt

Hopper

Pres. Line

Mixer

Silo

Other

Pressure Type

Positive

Negative

Atmospheric

Pressure Above

PSI

HG

H₂O

Size of Inlet/Outlet

Inches

Millimeters

Inlet/Outlet Shape

Circle

Square

Rectangle

Head of Product

Continuous Feed

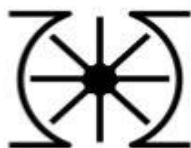

Equipment Below Rotary Valve

Chute

Shredder

Screw

Vac. Line

Cyclone

Belt

Hopper

Pres. Line

Mixer

Silo

Pressure Type

Positive

Negative

Atmospheric

Pressure Below

PSI

HG

H₂O

Metering

Non-metering

Product Description

Product Temperature

°F

°C

Bulk Density

PCF

PPH

Rate

kg/h

kg/m³

Product Characteristic

Abrasive

Explosive

Tends to Pack

Heat Sensor

Hydroscopic

Corrosive

Other

Particle Shape

Powder

Fibrous

Chip

Pellet

Flake

Particle Size

Inches

Millimeters

Mesh

Microns

Motor Requirements

Volts (V) / Phase / Frequency (Hz)

Instrumentation

Volts (V) / Phase / Frequency (Hz)

Motor Enclosure

TEFC

Explosion Proof

Inverter Duty

Other

Drive Options

No Drive

Direct

Chain

Right Angle

Parallel

Slave Drive

Other

Guard

Plastic

Aluminum

Carbon Steel

Carbon Steel with Front and Bottom

Other

Other Options and Requirements

(ex. Air Purge, Motion Switch, etc.)

Exterior Paint

Standard Schenck White

Other

Materials of Construction

Gray Iron

Aluminum

Carbon Steel

Stainless Steel

Coatings

Chrome

Nedox

Ceramic

Tungsten Carbide

Epoxy

Other

Packaging

Pallet (Standard)

Skeleton

Full Crate

Export Crate

Filter Application Form



Name

First Name

Last Name

Job Title

Company Name

Address

Street Address Line

City

State

Zip Code

Country

Phone Number

Area Code

Phone Number

Email

Is it a Replacement or New Application?

Replacement

New Application

Manufacturer

Model Number

Serial Number

Location Hazardous Area Certification

Indoors

Outdoors

Operating Pressure

PSI

HG

H₂O

Pressure Type

Atmospheric

Positive

Negative

Desired Rating of Dust Collector

PSI

In HG

WC

Inlet Type

Tangential

Radial

Hopper

High Entry

Bin Vent

Pneumatic Reciever

Other

Inlet Loading

lb/hr

grains/ft³

Pmax

bar

Explosion Vents

Unknown

Yes

No

KST

bar-m/sec

Required Outlet Emission

gr/ft³

mg/m³

Housing Type

Round

Square

Photohelic

Magnehelic

Hopper Discharge

size

Clearance below discharge

Support Structure

Yes

No

Timer Controls

Yes

No

Air to Cloth Ratio

Service Platform

Yes

No

Other Options and Requirements

Product Name/Description

ACFM

SCFM

Elevation

Max Temperature Range

°F

°C

Bulk Density

Moisture Percentage

%

Filtration Gas

Air

Nitrogen

Product Characteristic

Abrasive

Sticky

Hygroscopic

Wet

Corrosive

Fume

Other

Particle Size

Inches

Millimeters

Mesh

Microns

Bag Accessibility

Top

Bottom

Cartridge/Bag

Bag

Cartridge

Voltage Requirements

Level Indicator

High

Low

Volts (V) / Phase / Frequency (Hz)

Airlines

Polyflo (Standard)

Copper

304 Stainless Steel

Rotation and Discharge (check all that apply)

Clockwise

Top

Upblast

Horizontal

Counterclockwise

Bottom

Downblast

TBD

Fan Information

Static Pressure

Fan Mount

Top

Side

Arrangement

V-Belt

Direct Drive

Outlet Damper

Yes

No

Exterior Paint

Standard Schenck White

Other

Materials of Construction Clean Air Plenum

Aluminum

Carbon Steel

304 Stainless Steel

316 Stainless Steel

Materials of Construction Dirty Air Plenum

Aluminum

Carbon Steel

304 Stainless Steel

316 Stainless Steel

Epoxy Options

Industrial

Food Grade

Filter Media (if not chosen by vendor)

Weld Requirements

CG 24

CG80

CG80

Other

Ground Wire Required

Yes

No

Filter Cage

Galvanized

Stainless Steel

Epoxy

Valve & Diverter Application Form

schenckprocess



Name

Job Title

Company Name

First Name

Last Name

Address

Street Address Line

City

State

Zip Code

Country

Phone Number

Email

Area Code

Phone Number

Is it a Replacement or New Application?

Replacement

New Application

Manufacturer

Model Number

Serial Number

Location

Indoors

Outdoors

Hazardous Area Certification

Pressure Type

Positive

Negative

Gravity

Line Pressure

PSI

HG

H₂O

Line Size

Inches

Millimeters

Inside Diameter

Outside Diameter

Inches

Millimeters

Inches

Millimeters

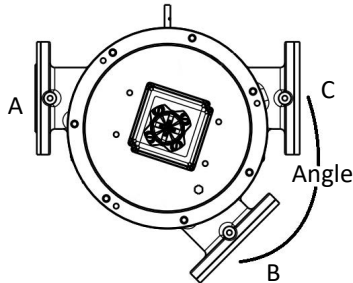

Angle = _____

A to B & C

B & C to A

End Type

Flanged End

Stubbed End

Actuator

Not Required

Linear (Electric Actuator)

Rotary (Rack and Pinion)

Manual

Linear (Air Cylinder)

Rotary (Vane)

Solenoid

Not Required

Single Coil

Double Coil

Limit Switch

Not Required

Mechanical Type

Proximity Type

Voltage Requirements

Volts (V) / Phase / Frequency (Hz)

Cavity Purge Kit Required

Yes

No

Position Indicator

Yes

No

Product Description

Product Temperature

°F

°C

Bulk Density

PCF

kg/m³

Rate

kg/h

PPH

Product Characteristic

Abrasive

Explosive

Tends to Pack

Heat Sensitive

Hygroscopic

Corrosive

Other _____

Particle Shape

Powder

Fibrous

Chip

Pellet

Flake

Other _____

Particle Size

Inches

Millimeters

Mesh

Microns

Housing Material of Construction

Carbon Steel

Cast Iron

Stainless Steel

Aluminum

Product Contact - Material of Construction

Aluminum

Stainless Steel

Packaging of Equipment

Pallet (Standard)

Skeleton Crate

Full Crate

Export Crate

Exterior Paint

Standard Schenck White

Other _____

Other Options and Requirements

(ex. Tag Number, Pre-Wire, etc)

ProDV® (Spheri Valve®) Application Form

schenckprocess



Name

Job Title

Company Name

First Name

Last Name

Address

Street Address Line

City

State

Zip Code

Country

Phone Number

Email

Area Code

Phone Number

Is it a Replacement or New Application?

Replacement

New Application

Manufacturer

Model Number

Serial Number

Location

Indoors

Outdoors

Hazardous Area Certification

ProDV® (Spheri Valve®) Size

_____ Inches

ProDV® (Spheri Valve®) Type

Bulkhead with Top Adapter

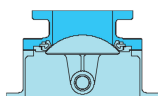

Bulkhead with Bottom Adapter

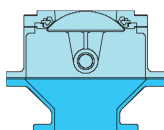

In-line

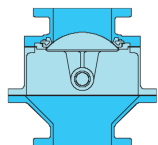

Inflatable Seal Material Type

Neoprene (Standard)

Viton

Blue Silicon (Food Grade)

Red Silicon (High Temp)

Other

Tungsten Carbide Coating

Yes

No

Plastite Interior Coating

Yes

No

Air Tube

PolyFlo

Stainless Steel

Copper

Exterior Paint Color

RAL9003 Signal White

RAL5002 Ultramarine Blue

Other

Packaging of Equipment

Pallet (Std)

Skeleton Crate

Full Crate

Export Crate

Product Description

Operating Temperature

°F

°C

Pressure Above Inlet Greater Than 7 PSI

Yes

No

Bulk Density

PCF

kg/m3

Rate

kg/h

PPH

Product Characteristic

Abrasive

Explosive

Hygroscopic

Heat Sensitive

Corrosive

Tends to Pack

Other

Particle Shape

Powder

Fibrous

Chip

Pellet

Flake

Other

Particle Size

Inches

Millimeters

Mesh

Microns

Actuator

Not Required

Rotary (Vane)

Linear (Air Cylinder)

Solenoid

Not Required

Single

Double

Voltage Requirements

Volts (V) / Phase / Frequency (Hz)

Position Indicator

Yes

No

Other Options and Requirements

Gate Valves Application Form



Name		Job Title	Company Name	
First Name	Last Name			
Address				
Street Address Line		City	State	Zip Code
Phone Number		Email		
Area Code	Phone Number			

Is it a Replacement or New Application?

Replacement	New Application	
Manufacturer	Model Number	Serial Number

Location

Indoors	Outdoors
---------	----------

Purpose of Valve

Divert Material Flow	Meter Material Flow	Process Gate
Maintenance Gate	Shut Off Material Flow	

Valve Size

Connection

Flanged	Stub
---------	------

Valve Shape

Round	Square	Rectangular
-------	--------	-------------

Piping/Tubing

Pipe	Schedule
Tubing	Gauge

Conveyance

Pressure	Vacuum	Gravity
----------	--------	---------

Pressure/Vacuum Rating

	PSI	HG	H ₂ O
--	-----	----	------------------

Material Contact

Carbon Steel	Aluminum	304 Stainless Steel
316L Stainless Steel		

Orientation of Valve

Horizontally	Vertically
--------------	------------

Equipment Below Gate Valve

Chute	Shredder	Screw	Vac. Line
Cyclone	Belt	Hopper	Pres. Line
Mixer	Silo	Other	

Equipment Above Gate Valve

Chute	Shredder	Screw	Vac. Line
Cyclone	Belt	Hopper	Pres. Line
Mixer	Silo	Other	

Product Description

Product Temperature

	°F	°C
--	----	----

Bulk Density

	PCF	PPH
--	-----	-----

Product Characteristic

Abrasive	Explosive	Hygroscopic
Corrosive	Tends to Pack	Other

Particle Shape

Powder	Fibrous	Chip
Pellet	Flake	Other

Particle Size

	Inches	Mesh	Millimeters	Microns
--	--------	------	-------------	---------

Actuator

Electric	Air Cylinder	Hand Crank	Wheel
----------	--------------	------------	-------

Controls Required

Solenoid	Position Indicator Switches
Pre-wired Terminal Box	

Close Through Material

Yes	No
-----	----

Voltage

110/120V	24VDC	220 VAC	Other
----------	-------	---------	-------

Class, Division, and Group

NEMA Rating

NEMA 4	NEMA 4X	NEMA 7/9
--------	---------	----------

ATEX Certification Required

Gas	Dust	Both	Not Required
-----	------	------	--------------

Other Options and Requirements

Name

First Name

Last Name

Job Title

Company Name

Address

Street Address Line

City

State

Zip Code

Country

Phone Number

Area Code

Phone Number

Email

Is it a Replacement or New Application?

Replacement

New Application

Manufacturer

Model Number

Serial Number

Product Description

Product Temperature

°F

°C

Bulk Density Min-Max

PCF

PPH

Product Characteristic

Abrasive

Explosive

Corrosive

Tends to Pack

Hygroscopic

Heat Sensor

Other

Particle Shape

Spherical

Fibrous

Granular

Flake

Crystal

Other

Particle Size Min-Max

Inches

Millimeters

Mesh

Microns

Process Feed Rate

kg/h

lbs/hr

Process

Batch

Continuous

Flow

Measuring Only

Measuring and Controlling

Accuracy Required

+/-

Required

Not Required

Refill Device Used

Bulk Bag

Rotary Feeder

Manual

Pneumatic Conveyor

Slide Gate

Screw Conveyor

Other

Equipment Below Feeder

Chute

Shredder

Cyclone

Belt

Mixer

Silo

Screw

Hopper

Other

Vac. Line

Pres. Line

Volumetric Refill Rate for Equipment Below Feeder

kg/h

lbs/hr

Material Degradation a Detriment to the Process

Yes

No

Downstream Device Inlet Dimensions

Downstream Vapors

Downstream Temperature

Downstream Pressure

Center of Inlet to Center of Discharge Dimension

Ambient Room Temperature Min-Max

°F

°C

Location

Indoor

Outdoor

Motor Proximity to Equipment

Computer Controller Proximity to Equipment

Allowable Equipment Envelope

Wide:

Deep:

High:

Environmental Conditions

Water Washdown

Chemical Washdown

Dust-Free

Sanitary

Explosive Atmosphere (Class, Division, Group(s))

Service

Industrial

Food

Pharmaceutical

Dairy

Motor Drive

Volts (V) / Phase / Frequency (Hz)

Instrumentation

Volts (V) / Phase / Frequency (Hz)

Host Communication

Yes

No

Device Brand/Model

Communication Protocol

Enclosure Mounting Style

Loose

19" Rack

Wall

Panel

NEMA Rating

Drive:

Instrumentation:

Estimated Wire Run Distance from Control to Equipment

Agency Approvals Required

UL

CSA

CE

Other

Other Options and Requirements

(ex. Air Punge, Motion Switch, etc.)